

THROUGH-HOLE CURRENT-COMPENSATED CHOKES

TRF122/222 SERIES

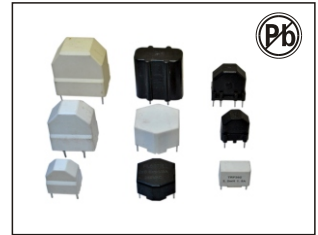

FEATURES:

- Excellent Mechanical Strength
- 100KHz to 3MHz common mode resonance
- High Reliability and variant PCB-mount housing
- Low resistance and temperature rise

COMMON APPLICATIONS:

- DC/DC, AC/DC line noise suppression
- Communication System
- Automotive Systems
- LCD/PDPTelevisions
- Computer Peripheral Equipment

ELECTRICAL CHARACTERISTICS :

Part Number	Inductance mH	Test Freq KHz	DCR (mΩ)Max	IDC (A)Max
TRF122/222-473Y	47	10	1180	0.6
TRF122/222-393Y	39	10	1000	0.8
TRF122/222-183Y	18	10	610	1
TRF122/222-103Y	10	10	220	1.5
TRF122/222-682Y	6.8	10	147	2
TRF122/222-332Y	3.3	10	45	4

TECHNICAL INFORMATION & PHYSICAL CHARACTERISTICS

TRF122

TRF222

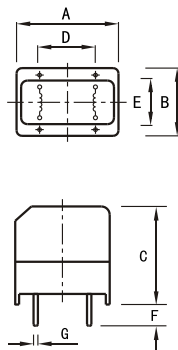
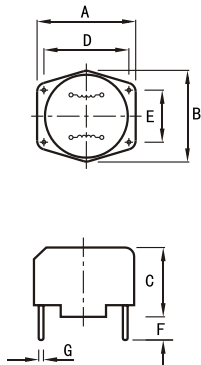

P/N	TRF122	TRF222
A	28	27
B	27	18
C	16.5	30
D	25	12.5
E	15	15
F	4	0.8
G	0.8	4

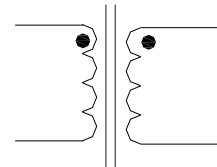

- Inductance tolerance..... +50% -30%
- Max operating voltage..... 250V at 40°C
- IDC Max..... rating AC/DC current A @40°C
- Hi-Pot..... 1500Vac winding to winding 3S
- Inductance Testing..... 10KHz 0.1V HP4284A
- Operating temperature..... -40°C to +105°C
- Storage Temperature..... -40°C to +105°C

Note:All specifications subject to change without notice.